



Hike - Bike - Explore - Enjoy Nature

Trail/Road Guide Key

| Trail / Road Name and Abbreviation | Bike* Route | Miles 37.33 total |
|------------------------------------|----------------|-------------------------|
| AZ Azalea | yes | 1.4 |
| BH Back Hollow Road | yes | 1.9 |
| BMR Bays Mountain Road | yes | 2.1 |
| BRR Bays Ridge Road | yes | 1.4 |
| BRT Bays Ridge Trail | no | 2.6 |
| BET Bear Run Trail | yes | 1.0 |
| BO Big Oak Trail | yes | 1.0 |
| CK Cherry Knobs | no | 1.6 |
| Chn Chinquapin Trail | yes | 1.85 |
| CF Cliffside Trail | no | 0.5 |
| CR Cross Ridges Trail | no | 0.7 |
| DB Dolan Branch Trail | no | 0.3 |
| FN Fern Trail | no | 0.2 |
| FT Fire Tower Trail | no | 0.7 |
| FP Food Plot Road | no | 0.45 |
| FH Front Hollow Road | yes | 1.8 |
| HM Hemlock Trail | no | 0.1 |
| HO Holly Trail | no | 0.4 |
| IP Indian Pipes Trail | yes | 2.0 |
| JR Jones Road (Jones Trail) | yes | 0.3 |
| KH Kiner Hollow Trail | yes | 1.6 |
| LK Lake Road | yes | 4.4 |
| LS Lakeside Trail | no | 2.3 |
| LR Laurel Run Trail | no | 2.0 |
| OR Orchard Trail | no | 0.4 |
| PN Pine Trail | no | 0.1 |
| PR Pretty Ridge Trail | yes | 1.9 |
| RM River Mountain Road | yes | 3.2 |
| SG Sweet Gum Trail | no | 150 feet |
| TO Towhee Trail | no | 0.1 |

* Inspection by park officials and sticker required.

www.baysmountain.com
(423) 229-9447

Laurel Run Park

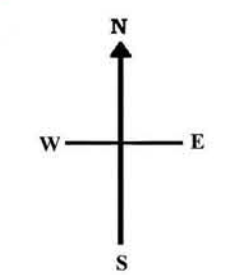
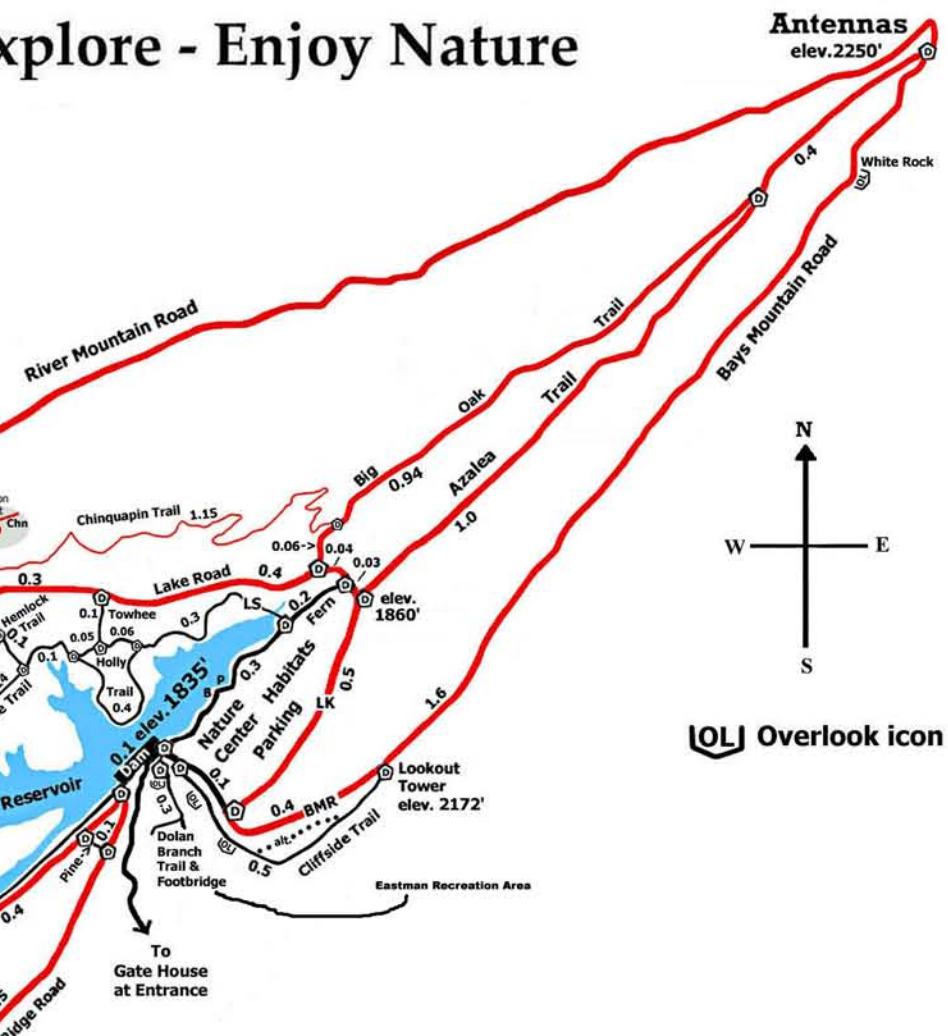
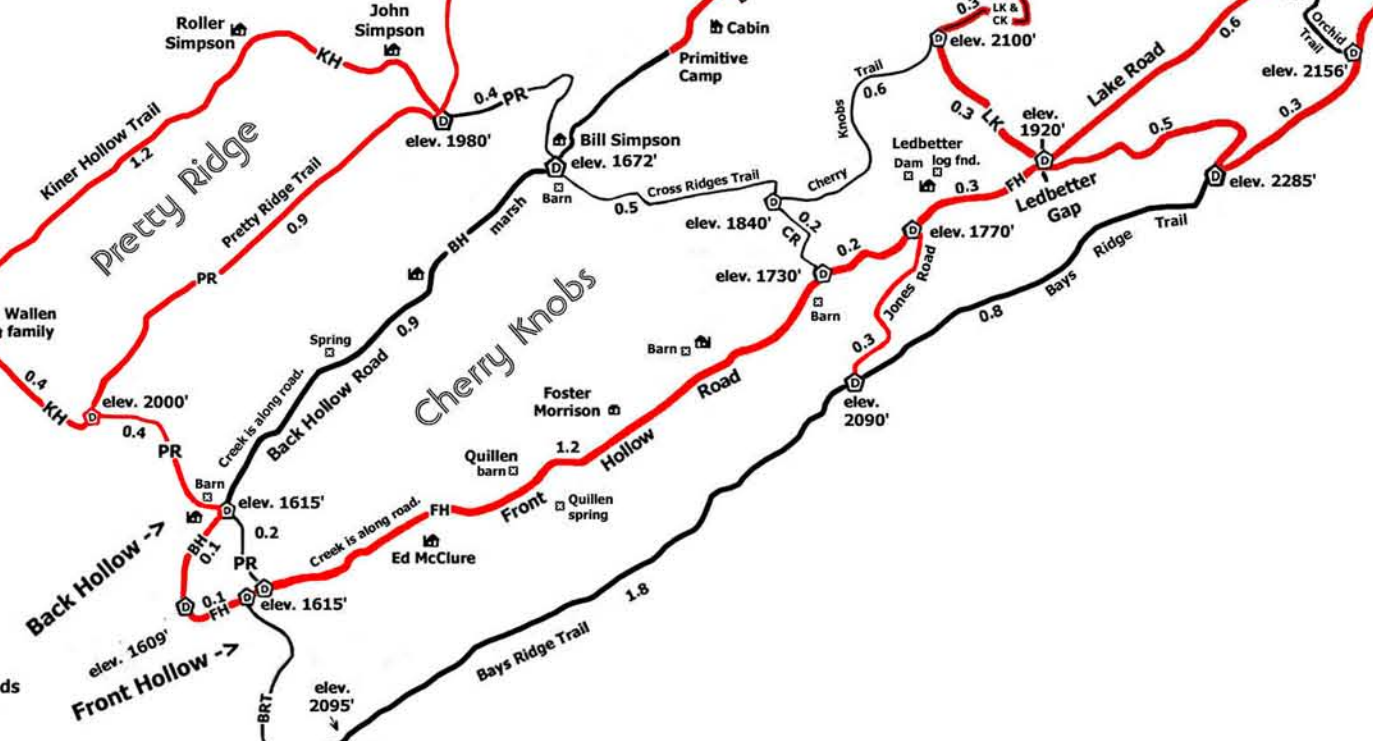
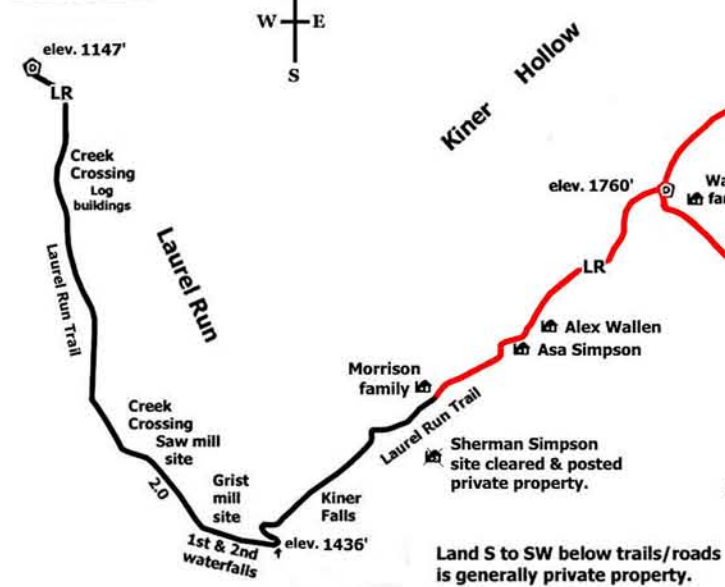

Overlook icon

WHEN HIKING AT BAYS MOUNTAIN PARK

1. Plan ahead: know your terrain. If you have questions, talk to a park naturalist.
2. **ALWAYS** take this map with you. Even the most experienced hikers can lose sense of direction and location.
3. Hike with a partner if possible. This can help ensure your safety and could also enhance the experience. **IF YOU DO GET LOST DO NOT SPLIT UP, STAY TOGETHER.**
4. Take a cell phone in case of emergency.
5. Know the environment you are going into. You will be entering a natural area featuring a variety of wildlife and plant species. For example, know how to recognize poison ivy.
6. **ALWAYS** be certain your hike will allow you to finish before the park closes.
7. Take drinking water with you and stay properly hydrated.
8. **IF YOU DO GET LOST**, call The Nature Center immediately at (423) 229-9447.

DISCLAIMER - User of Trail/Road Guide and information contained thereon accepts full responsibility and risks for and from such use.

Bays Mtn. Park is Licensed Distributor of Trail/Road Guide
Copyright © 2008 by Allen Duffield

WELCOME TO BAYS MOUNTAIN PARK

Regular Hours

Mon-Fri 8:30am-5:00pm
 Saturday 8:30am-8:00pm
 Sunday noon-8:00pm

Winter Hours

Nov-Dec-Jan-Feb
 Mon-Sat 8:30am-5:00pm
 Sunday noon-5:00pm

Summer Hours

June-July-August

Mon-Sat 8:30am-8:00pm
 Sunday noon-8:00pm

Closed

New Years Day
 Thanksgiving Day
 Christmas Eve & Christmas Day

GATES LOCKED PROMPTLY AT CLOSING TIME

Bays Mountain Park sits in a 3,550 acre natural basin which includes the old City of Kingsport reservoir that today serves as a 44 acre lake habitat. Constructed in 1917, the reservoir provided Kingsport water until 1944. A group of citizens then put in motion a plan to preserve Bays Mountain for public use. Bays Mountain Park opened in 1971 and is owned and managed by the City of Kingsport.

Habitats include shady forests, ponds, streams, natural seeps, and rocky outcrops. Typical Appalachian plants and animals inhabit the park including deer, squirrels, raccoons, a variety of bird species and many others.

In order to maintain the park in its natural condition collection of plants or animals, living or dead, is prohibited. Bays Mountain Park is a nature preserve.

ANIMAL HABITATS - Enclosed animal habitats feature those species that live or once lived in East Tennessee. All of our animals are fed a nutritious diet. **PLEASE DO NOT FEED THEM.**

PICNIC AREAS - Picnics areas are set up between the parking lots for your convenience. Additional picnic shelters can be found on Lake Road just above Raptor Center and just above the astronomy observatory. **NO FIRES OR USE OF GRILLS ARE ALLOWED.**

FISHING - Fishing is available to visitors under the age of 16 or over the age of 55, on Monday and Saturday from 8:30 a.m. until noon. In June, July and August fishing times are Monday thru Saturday from 8:30 a.m. to noon. All fishing **MUST** take place at the dam and **NO** live minnows are permitted. Tennessee state fishing regulations apply.

ROLLER SPORTS - Skateboarding, rollerblading and other roller sports are not permitted on park grounds.

Remember, Bays Mountain Park is a nature preserve. Please help protect park wildlife by not feeding them or leaving your unwanted trash. Please dispose all trash and food promptly.

For information on park memberships, getting involved in the Bays Mountain Astronomy Club, becoming a park volunteer or detailed descriptions of park programs visit us at the gift shop in the Nature Center or view online at www.baysmountain.com.



WILDLIFE ENCOUNTERS - JUST IN CASE

You are entering an area frequently inhabited by wildlife. Never feed or entice wild animals to approach you, and:

1. Picnic in designated picnic areas **ONLY!**
2. **DO NOT** carry food on the trails.

BEAR ENCOUNTERS - Black bear are rarely aggressive toward humans. Please heed the following advice:

1. Make noise when hiking so you do not surprise a bear.
2. If you encounter a bear stay calm. **DO NOT** run away or make sudden movements. Slowly back away and then leave the area.

PROGRAMS FOR EVERYONE!!!

Bays Mountain Park offers a wide variety of fun things to enjoy on your visit:

NATURE PROGRAMS - Utilizing a 3,550-acre outdoor classroom, park naturalists offer programs like a barge ride on our 44-acre lake and educational topics such as snakes, raptors and wolves. Tickets are just \$1.50 per person.

ASTRONOMY - Featuring a state-of-the-art planetarium, our astronomy staff are eager to take you on a journey beyond your imagination. Shows are only \$3.00 per person.

StarWatch and SunWatch programs are offered seasonally and are free to the public.

POLICY FOR DOGS AT THE PARK

Guidelines for visiting the park with your dog:

- Dogs are not allowed in the enclosed animal habitats area. Signs are posted for your convenience.
- All dogs must be kept under physical control and on a leash at all times. **Sorry, no dogs permitted in programs.**
- Please be considerate and clean up any dog feces.
- Do not leave your pet unattended or tied to an object.
- Bays Mountain Park is not responsible for any exchange of disease between your pet and wildlife.
- There is a possibility your pet could become prey for a bear, coyote, owl, or other predator.